

BIOMIMETIC MANUFACTURING

TONY SCHMITZ

PROFESSOR

UNC CHARLOTTE

MECHANICAL ENGINEERING AND ENGINEERING SCIENCE



Background

The inaugural NAMRI/SME David Dornfeld Manufacturing Vision Award and Blue Sky Competition, funded by the National Science Foundation, was held during SME's annual North American Manufacturing Research Conference (NAMRC), June, 2017.

Desired outcomes

- present new ideas and vision for manufacturing research and education
- consider the “outrageous” by asking new questions
- present new challenges in new application domains requiring new approaches
- provide bold vision of the future of manufacturing.

This presentation received the NAMRI/SME Dornfeld Manufacturing Vision Award, named in honor of the late David Dornfeld, PhD, FSME.

Agenda

Vision statement

Biomimetic examples

Biomimetic manufacturing inspiration

- Trees
- Bean sprouts
- Termites
- Beaver teeth
- Zika virus



**Blue sky
question**



Existing field

Biomimetics uses models, systems, and elements from nature to solve complex human problems.

Vision statement

Next generation manufacturing innovation will be enabled by imitating biological systems in production environments.

Well-known biomimetic examples

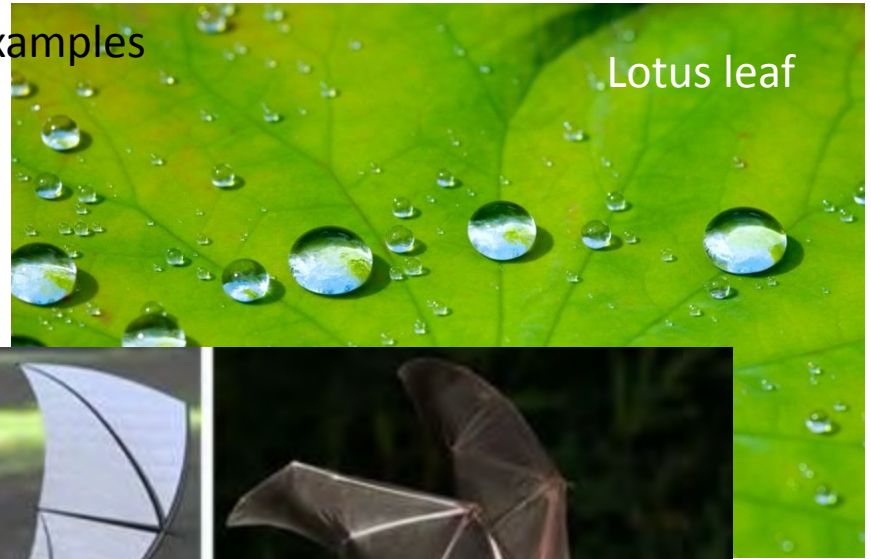

Lotus leaf

Gecko feet

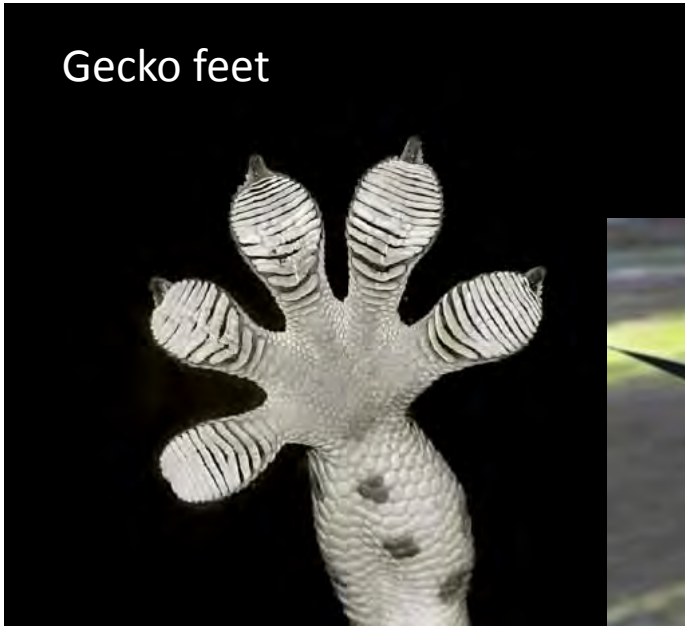

Flapping wing MAVs



Sharkskin swimsuit



Velcro

Let's consider five possible sources for biomimetic manufacturing inspiration:

- trees
- bean sprouts
- termites
- beaver teeth
- Zika virus.



Trees

- Growth pattern provides strength and geometry
- Meristems are locations of cell division that provide tree growth
- Apical meristems are found at branch and root tips
- Vascular cambium enables diameter growth



Tree growth is not layer-by-layer.

A “layered” tree:

- wouldn't last in a strong wind
- would require support material when growing new branches.

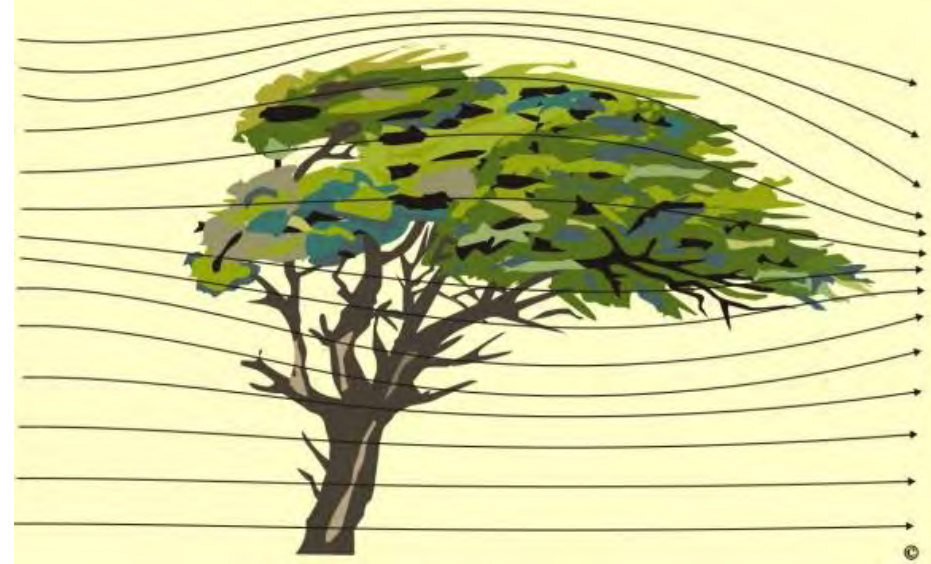

Support material

Blue sky question: Should additive manufacturing proceed in layers or could other approaches be applied that mimic tree growth?

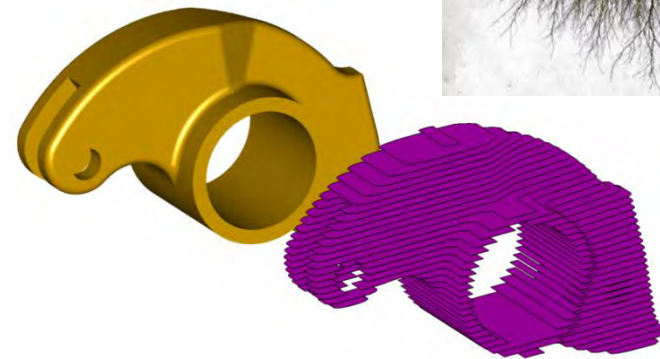

Are other addition (growth) strategies available that could increase isotropy, strength, fatigue life, or surface quality?

Beans sprouts

- water dissolves the hard seed casing
- casing splits
- roots emerge and unfurl from the seed
- leaf growth begins
- pair of leaves unwrap from the stem.



How do we currently create deployable assemblies?

- manufacture parts
- assemble
- fold
- deploy.

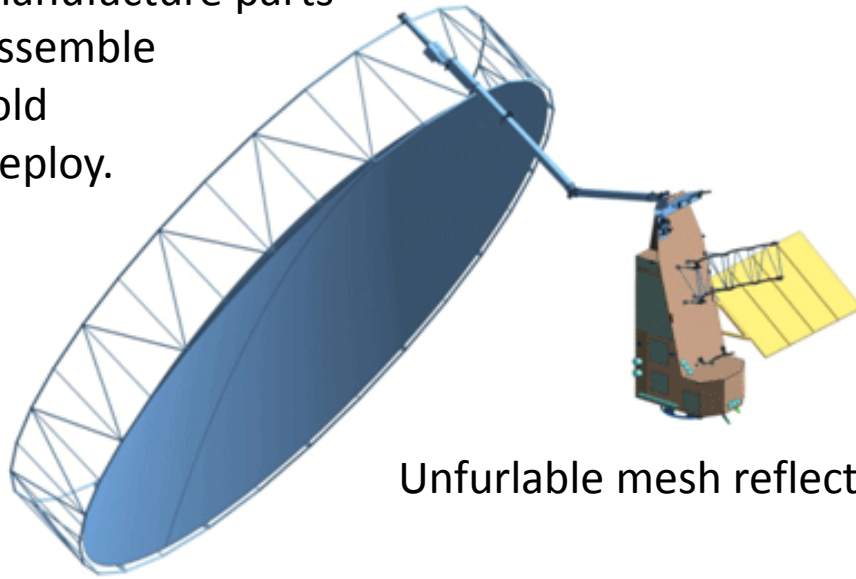

Unfurlable mesh reflector antenna concepts

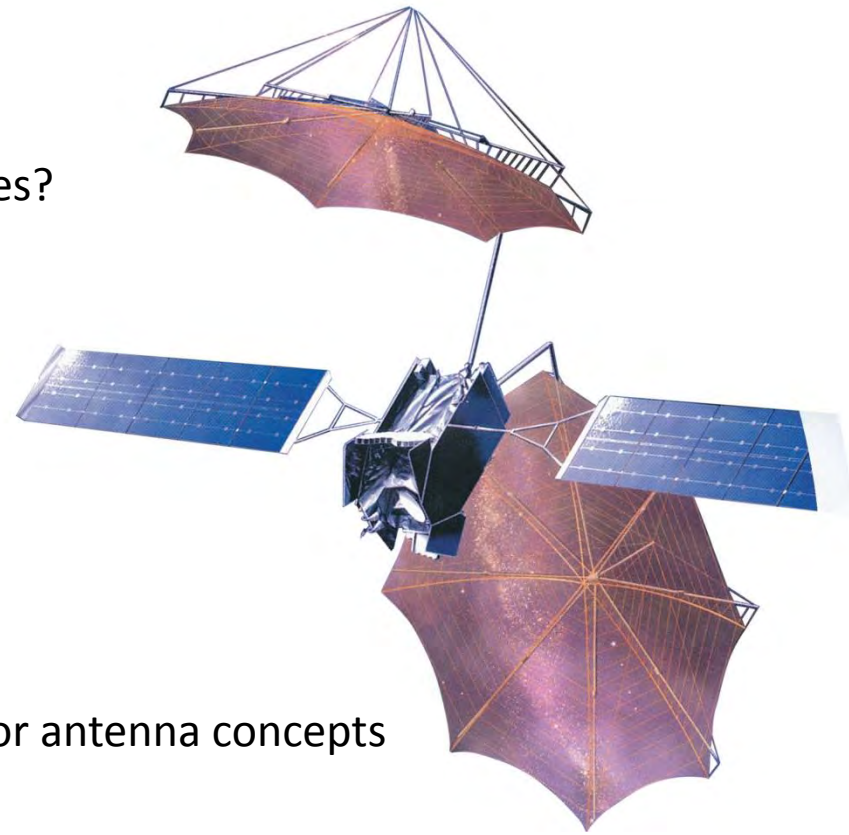

Blue sky question: Could new materials and designs be created that enable assemblies to be produced monolithically and then deployed?

What about a UV *un*-curable polymer? Print the device closed and then “un-cure” it to deploy.

Termites

- communicate by vibrations
- swarm to produce a new colony
- produce enzymes that break down wood cellulose into sugars they can digest.



Wood digestion



Termite poop
with protozoa and bacteria

Break down wood cellulose
into digestible sugars

Termites are normally considered a pest, but can we leverage their behavior for manufacturing?



Blue sky question: Can we realize tailored material removal using a termite swarm concept?

Can we create a new “machining” paradigm using:

- a swarm of autonomous meso-scale robots
- massively parallel material removal, including internal features
- part “digestion”, waste collection, and recycling
- controlled number/density of robots
- controlled “eating” direction and rate?

Beaver teeth

- incisors are self-sharpening
- outer surface composed of hard enamel
- inner portion made of softer dentin.

As the dentin quickly wears, the cutting edge remains sharp. The tooth also continuously grows, which compensates for the high dentin wear rate.

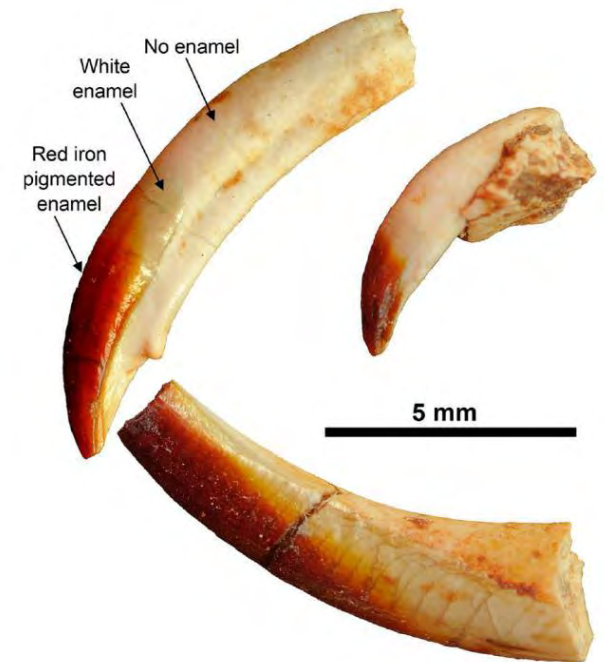



Blue sky question: Could cutting tool designs evolve to accommodate, rather than minimize, wear and subsequently improve machining productivity?

Instead of new coating/material technology, could new designs “grow” at an appropriate rate and self-sharpen using the hard/soft layer concept?



Zika virus

- spread primarily by mosquitoes
- first isolated in Uganda (1947)
- spread to the Americas starting in 2007
- 2015-16 epidemic
- no vaccine.

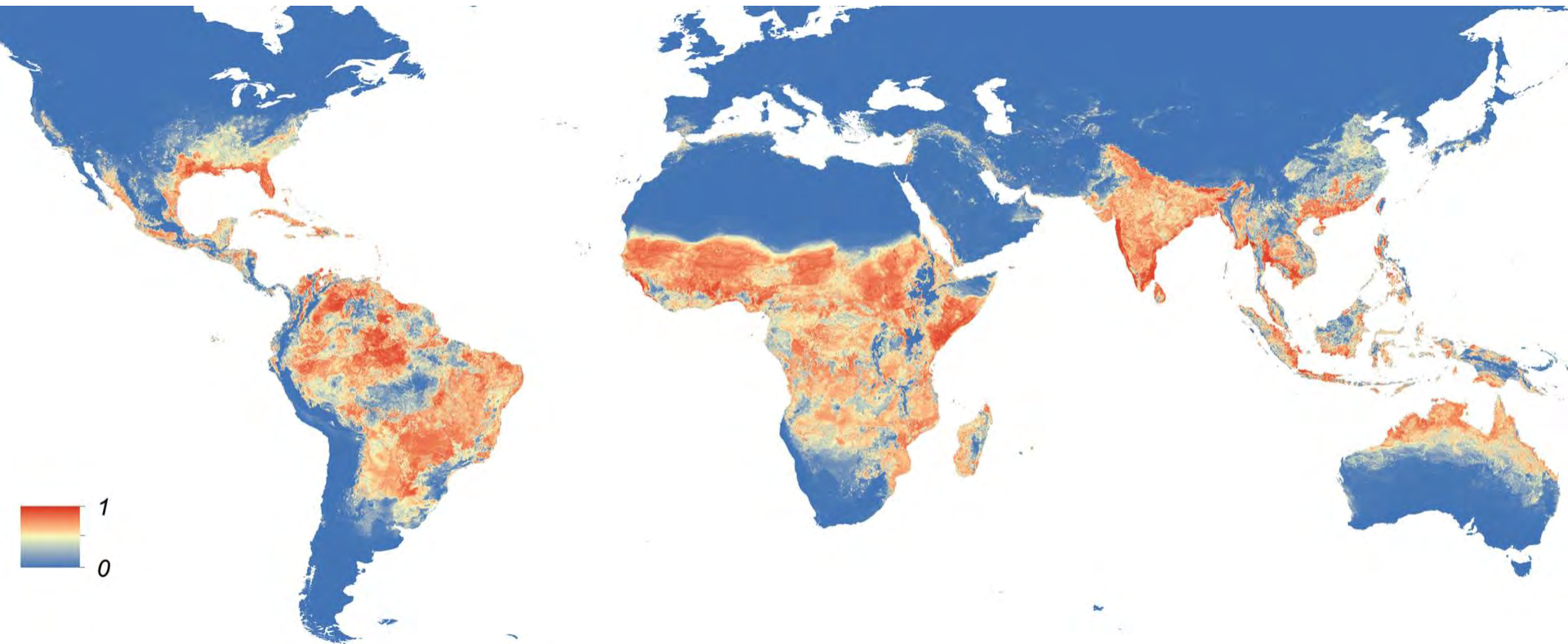

Digital twin

- computerized companion of physical asset
- data can include CAD/CAM, processing, geometry, property information
- can represent (near) real-time status, working condition, or position.



Blue sky question: Can we share the digital twin with everything a part touches creating a data “outbreak”?

The digital twin becomes the **digital army** when computerized part information spreads like the Zika virus.

Will create new “big data” management questions.



Research possibilities + ... education opportunities

- intersection of manufacturing science and biology will promote cross-pollination of two disciplines
- biological programs are typically more diverse than manufacturing with a much higher percentage of female students
- provide a much-needed step change in manufacturing research participation by under-represented groups
- inherently lead to innovation through increased diversity.

In remembrance



Biomimetic Manufacturing

Tony Schmitz
UNC Charlotte

Questions?

